

**COXPAL**

# User Manual

---

Model No: **A7 Dual HW**

## 1. Product Overview

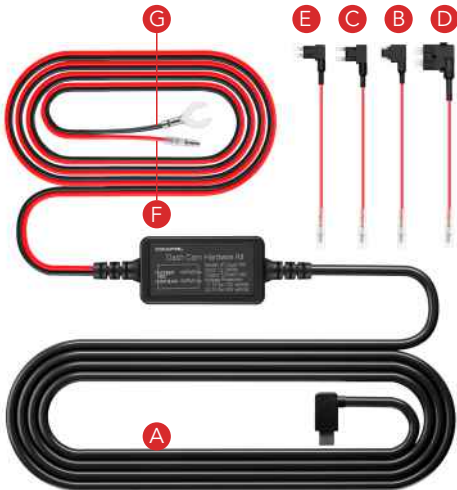

A. Dash Cam Hardwire Kit

E. Micro2 Add-A-Circuit  
Fuse Holder

B. Mini/LP ACN Add-A-Circuit  
Fuse Holder

F. Red Wire to Fuse Box

C. Mini ACS Add-A-Circuit Fuse  
Holder

G. Black Wire to the Ground

D. ATO ACU Add-A-Circuit Fuse  
Holder

## 2. Specifications

Name	Description
Connector	USB Type-C
Input Voltage	DC 12V-24V
Output Voltage	DC 5V
Output Current	1.5A
Working Temperature	-22°F ~ 167°F (-30°C ~ 75°C)
Cable Length	3.5m (11ft)
Low Voltage Protection	11.7V for 12V vehicle; 23.7V for 24V vehicle.

## 3. Installation

### 1. Locate your fuse box

Use your vehicle's owner manual to identify the location of the internal fuse box. This is normally found by the foot well on the driver's side of your vehicle. You may need a tool to gain access.

### 2. Find the correct fuse slot for your hardwire kit

Next you need to find the fuse map which is a diagram describing what each fuse does and where it's located in the box. This simplifies the process and ensures you don't pull the airbag fuse.

Or you will need a circuit tester or multimeter to test if a fuse is ignition switched or always on. If you need to find an ignition switched fuse, put the key in the vehicle, find the fuse which is not lit up while the car is off, and test it by turning the car on to see if it lights up. If your kit requires constant power, turn off the car and remove the key to see which fuse slots stays lit on.

### 3. Identify your fuse type

Next you need to identify the type of fuse.

#### 4. Connect to car fuse box

- a. Once you've determined which fuse slots you need to use for your hardwiring kit you can crimp the red wire of your hardwire kit onto the Add-A-Fuse.

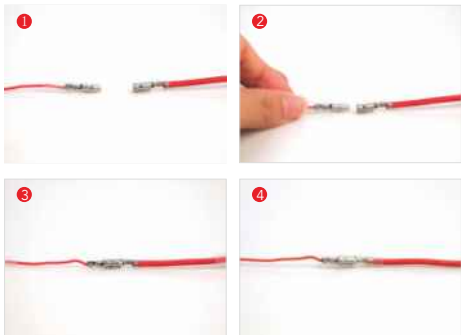

- b. Make sure the key has been removed from the ignition. Using a fuse puller or a pair of pliers, gently remove the fuse you identified.



- c. Install the fuse you just removed into the installation kit add-a-fuse circuit.



- d. Plug the add-a-circuit into the fuse box in the correct orientation.



## 5. Ground the hardwiring kit

- a. Next, slip the black wire (which is in the shape of a C) under a metal bolt or screw in your vehicle (this is the ground wire). Using a multimeter, check that it is not attached onto plastic parts. You will typically need a socket wrench to loosen the nut or bolt that you choose to ground with. To attach the grounding terminal, loosen the nut or bolt enough to slip it in and tighten it back up afterwards. A loose ground can result in power issues for your dash cam.



## 6. Test your installation

- a. Connect the dash cam with the hardwire kit. If everything was installed correctly, you should see your dashcam turn on and begin recording! At this point you may go ahead and reinstall all interior panels that were removed to facilitate running the power cable.

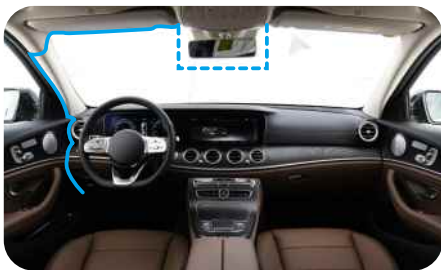

## Warranty & Support

**Warranty:** Full 12-month since the date of purchase.

**Support:** [support@coxpal.com](mailto:support@coxpal.com)

Recommended Mail Subject Format for quickly handling your case:

Model No + Purchase Channel + Order ID

For example:

Subject

### **Your opinion matters!**

Coxpal is firmly committed to continually improving our products, services, and user experience. If you have any thoughts on how we can do even better, we always welcome your constructive feedback and suggestions.

**COXPAL**

[www.coxpal.com](http://www.coxpal.com)



Made in China